

# FALCON X SERIES

## FCN-X

IP40 IK10

Falcon X series feature linear profile are designed for illumination of larger open space and aisle applications, in particular sports applications. Constructed in high quality sheet steel for excellent thermal performance with various options of optic to suit varied application areas which includes sports hall, gymnasium, multipurpose halls, industrial spaces.



### FEATURES

FINISH	Black, White, Silver
LAMP LIFE	L80 B50, 100,000Hours
MOUNTING	Suspended, Surface mounted
CONNECTION	Indoor rated connections
DIMENSIONS	1160x300, 340, 600x82mm
BEAM ANGLE	90°, 120°
OPERATION TEMP	-25° C - +50° C
LUMEN	140lm/W

### ELECTRICAL DATA

POWER CONSUMPTION	80W, 100W, 140W, 160W, 180W, 200W, 280W
SUPPLY VOLTAGE	220-240V AC 50-60Hz
CRI	>80
COLORS	3000K/4000K/6500K
MacAdam	3SDCM, 2SDCM (On request)

PHILIPS, EPISTAR, NICHIA, SAMSUNG, LUMILEDS, BRIDGELUX, OSRAM  
LED Quality

220-240V AC  
Working Voltage

80W/100W/140W/160W/180W/200W/280W  
Rated power

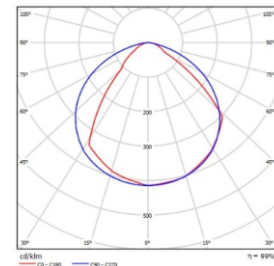

### DIMENSIONS

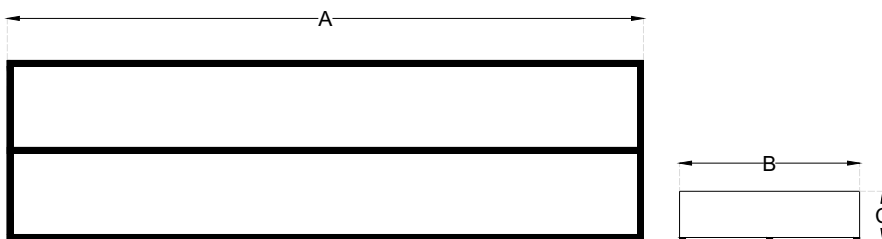

POWER	A	B	C
80, 100, 140	1160	300	82
160, 180	1160	340	82
200, 280	1160	600	82

### ORDERING LOGIC

PRODUCT	WATTAGE	COLOR TEMPERATURE	INPUT VOLTAGE	FINISH	CONTROL	DIFFUSER	CUSTOM
FCN-X	80 - 80W	(CT 30) 3000K	AC - 220-240V AC	BK - Black	SW - On-Off	CL - Clear	XXX
	100 - 100W	(CT 40) 4000K		WH - White	DA - DALI	FR - Frosted	
	140 - 140W	(CT 65) 6500K		SL - Silver		CTG Clear tempered glass	
	160 - 160W	(CTXX) CUSTOM				FTL Frosted tempered glass	
	180 - 180W						
	200 - 200W						
	280 - 280W						

Sample: FCN-X - 80 - CT30 - AC - BK - SW - CL - XX