

# LINEAR WALLWASHER SERIES

## LWW PLUS- RGB/RGBW



YYZ LWW Plus series is a new solution of large-scale high brightness architectural illumination like facade, bridge, retail and hospitality applications. This IP66 rated fixture is with AC line input, high performance linear luminaire for washing or grazing exterior facades. It is equipped with high-brightness LEDs, it offers impressive wall-washing and signage illumination. Available in multiple optic designs, this series can use a combination of color and beam angles to support a variety of architecture applications.



### FEATURES

|                  |   |
|------------------|---|
| FINISH           | 6063 High density aluminum                |
| WORKING VOLTAGE  | 100-277 Vac                               |
| RATED POWER      | 12/24/36/48W                              |
| BEAM ANGLE       | 15°, 20°, 35°, 50°. 10x40°                |
| AVAILABLE LENGTH | 304mm, 598mm, 891mm, 1183mm               |
| MOUNTING         | Surface mounting                          |
| OPTIC            | Clear tempered glass                      |
| DIMENSIONS       | 304, 598, 894, 1183(L) x 60(B) x 61..5(H) |
| OPERATING TEMP   | -5° C - +50° C                            |
| STORAGE TEMP     | -20° C - +60° C                           |
| LAMP LIFE        | 50,000 hrs                                |
| BODY COLOR       | Black, Grey, White                        |
| CONTROL          | On/Off, Triac, 0-10V, Dali                |

CREE / NICHIA  
LED Quality

100-277 VAC  
Working Voltage

12W, 24W, 36W, 48W  
Rated power

### ELECTRICAL DATA

|                   |                     |
|-------------------|---------------------|
| POWER CONSUMPTION | 12/24/36/48W        |
| SUPPLY VOLTAGE    | 100-277 Vac         |
| COLORS            | RGB, RGBW           |
| CRI               | 90+                 |
| LUMEN             | 90-100 lm/W @ 3500K |

### DIMENSION

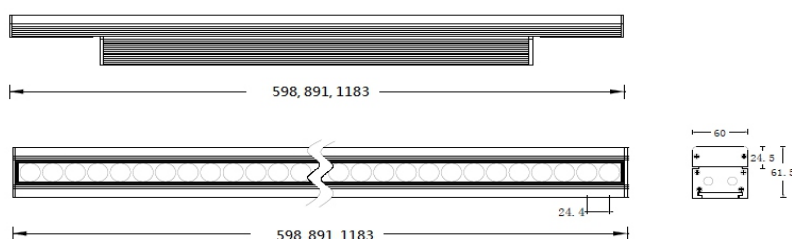

### ORDERING LOGIC

| PRODUCT  | POWER             | OPTIC | COLOR TEMPERATURE | CONTROL | VOLTAGE          | FIXTURE LENGTH      | BODY COLOR | CUSTOM |
|----------|-------------------|-------|-------------------|---------|------------------|---------------------|------------|--------|
| LWW PLUS | 12 - 12W (304mm)  | 15    | 15° (RGB)         | RGB     | 277 - 100-277VAC | 304 - 304mm (12W)   | BK - BLACK | XX     |
|          | 24 - 24W (598mm)  | 20    | 20° (RGBW)        | RGBW    |                  | 598 - 598mm (24W)   | GR - GRAY  |        |
|          | 36 - 36W (891mm)  | 30    | 30°               |         |                  | 891 - 891mm (36W)   | WH - WHITE |        |
|          | 48 - 48W (1183mm) | 50    | 50°               |         |                  | 1183 - 1183mm (48W) |            |        |
|          |                   | 10x40 | 10° x 40°         |         |                  |                     |            |        |

Sample: LWW PLUS - 12 - 15 - RGB - DX - 277 - 304 - BK - XX

## LWW PLUS- RGB/RGBW

### ACCESSORIES

#### Mounting Bracket



**LWWMBA**  
Description: DPMB is an adjustable mounting option are used for applications that require angle adjustments.

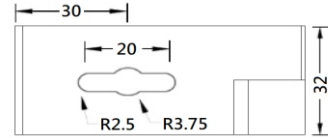

#### Glare Control



**LWWGLS-304/598/891/1183**  
YYZ LWW anti-glare lover symmetric



**LWWGLA-304/598/891/1183**  
YYZ LWW anti-glare lover asymmetric

### EXTENSION CABLE

| Part Number         | Product Image | Length (mm) | Application   | Cable end  |         | Conductor size   |
|---------------------|---------------|-------------|---|--|---------|--|
| YYZCF-250-3pin-XX   |               | 250         | Power Lead  | Female   | Bare    | 3 x 16AWG (1.5mm <sup>2</sup> )  |
| YYZCF-2000-3pin-XX  |               | 2000        |   |  |         |  |
| YYZCF-6000-3pin-XX  |               | 6000        |   |  |         |  |
| YYZCF-15000-3pin-XX |               | 15000       |   |  |         |  |
| YYZCF(Shield)-250   |               | 250         | Data Lead   | Female   | Bare    | 3 x 22AWG Shield (0.3mm <sup>2</sup> )                                   |
| YYZCF(Shield)-2000  |               | 2000        |   |  |         |  |
| YYZCF(Shield)-6000  |               | 6000        |   |  |         |  |
| YYZCF(Shield)-15000 |               | 15000       |   |  |         |  |
| YYZCF-250-6pin-XX   |               | 250         | Power and Data Combined Lead                        | Female   | Bare    | 3 x 16AWG (1.5mm <sup>2</sup> ) + 3 x 22AWG Shield (0.3mm <sup>2</sup> ) |
| YYZCF-2000-6pin-XX  |               | 2000        |   |  |         |  |
| YYZCF-6000-6pin-XX  |               | 6000        |   |  |         |  |
| YYZCF-15000-6pin-XX |               | 15000       |   |  |         |  |
| YYZCL-003-6pin-XX   |               | 300         | Power and Data Combined Extension Cable             | Female   | Male    | 3 x 16AWG (1.5mm <sup>2</sup> ) + 3 x 22AWG Shield (0.3mm <sup>2</sup> ) |
| YYZCL-020-6pin-XX   |               | 2000        |   |  |         |  |
| YYZCL-060-6pin-XX   |               | 6000        |   |  |         |  |
| DMX-TER-AC-6pin-M   |               | N/A         | DMX Terminator                                      | Male   | End Cap |  |
| AC-LEADIN-T336      |               | N/A         | T-connector for DMX and Power Lead                  | Combines the power (3 pin male), DMX signal (3 pin male) into a 6 pin female leading end |         |  |
| AC-P-INJECT-T636    |               |             | T connector for the 6 pin cable with power injector | T connector 6-pin male to 6-pin female with AC male power injector                       |         |  |