

# LINEAR WALLWASHER SERIES

## LWW PLUS- DWT



YYZ LWW Plus series is a new solution of large-scale high brightness architectural illumination like facade, bridge, retail and hospitality applications. This IP66 rated fixture is with AC line input, high performance linear luminaire for washing or grazing exterior facades. It is equipped with high-brightness LEDs, it offers impressive wall-washing and signage illumination. Available in multiple optic designs, this series can use a combination of color and beam angles to support a variety of architecture applications.



### FEATURES

FINISH	6063 High density aluminum
WORKING VOLTAGE	100-277 Vac
RATED POWER	12/24/36/48W
BEAM ANGLE	15°, 20°, 35°, 50°. 10x40°
AVAILABLE LENGTH	304mm, 598mm, 891mm, 1183mm
MOUNTING	Surface mounting
OPTIC	Clear tempered glass
DIMENSIONS	304, 598, 894, 1183(L) x 60(B) x 61..5(H)
OPERATING TEMP	-5° C - +50° C
STORAGE TEMP	-20° C - +60° C
LAMP LIFE	50,000 hrs
BODY COLOR	Black, Grey, White
CONTROL	On/Off, Triac, 0-10V, Dali

CREE / NICHIA  
LED Quality

100-277 VAC  
Working Voltage

12W, 24W, 36W, 48W  
Rated power

### ELECTRICAL DATA

POWER CONSUMPTION	12/24/36/48W
SUPPLY VOLTAGE	100-277 Vac
COLORS	2700-5700K
CRI	90+
LUMEN	90-100 lm/W @ 3500K

### DIMENSION

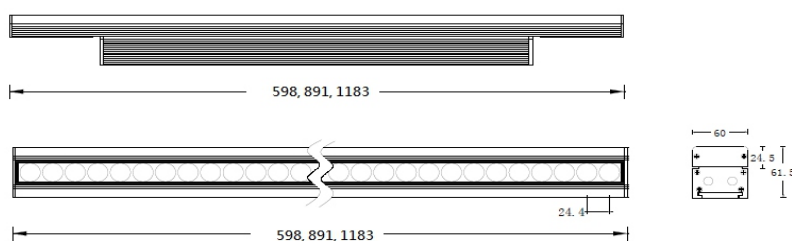

### ORDERING LOGIC

PRODUCT	POWER	OPTIC	COLOR TEMPERATURE	CONTROL	VOLTAGE	FIXTURE LENGTH	BODY COLOR	CUSTOM
LWW PLUS-DWT	12 - 12W (304mm)	15 - 15°	(DWT) 2000-5700K	SW - On/Off	277 - 100-277VAC	304 - 304mm (12W)	BK - BLACK	XX
	24 - 24W (598mm)	20 - 20°		TR - Triac		598 - 598mm (24W)	GR - GRAY	
	36 - 36W (891mm)	35 - 35°		AN - 0-10V		891 - 891mm (36W)	WH - WHITE	
	48 - 48W (1183mm)	50 - 50°		DA - Dali		1183 - 1183mm (48W)		
		10x40 - 10° x 40°						

Sample: LWW PLUS-DWT - 12 - 15 - DWT - SW - 277 - 304 - BK - XX

## LWW PLUS- DWT

### ACCESSORIES

#### Mounting Bracket



**LWWMBA**  
Description: DPMBAs are adjustable mounting options used for applications that require angle adjustments.

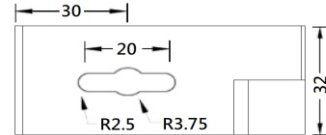

#### Glare Control



**LWWGLS-304/598/891/1183**  
YYZ LWW anti-glare lover symmetric



**LWWGLA-304/598/891/1183**  
YYZ LWW anti-glare lover asymmetric

### EXTENSION CABLE

Part Number	Product Image	Length (mm)	Application	Cable end		Conductor size
YYZCF-250-3pin-XX		250	Power Lead	Female	Bare	3 x 16AWG (1.5mm <sup>2</sup> )
YYZCF-2000-3pin-XX		2000				
YYZCF-6000-3pin-XX		6000				
YYZCF-15000-3pin-XX		15000				
YYZCF(Shield)-250		250	Data Lead	Female	Bare	3 x 22AWG Shield (0.3mm <sup>2</sup> )
YYZCF(Shield)-2000		2000				
YYZCF(Shield)-6000		6000				
YYZCF(Shield)-15000		15000				
YYZCF-250-6pin-XX		250	Power and Data Combined Lead	Female	Bare	3 x 16AWG (1.5mm <sup>2</sup> ) + 3 x 22AWG Shield (0.3mm <sup>2</sup> )
YYZCF-2000-6pin-XX		2000				
YYZCF-6000-6pin-XX		6000				
YYZCF-15000-6pin-XX		15000				
YYZCL-003-6pin-XX		300	Power and Data Combined Extension Cable	Female	Male	3 x 16AWG (1.5mm <sup>2</sup> ) + 3 x 22AWG Shield (0.3mm <sup>2</sup> )
YYZCL-020-6pin-XX		2000				
YYZCL-060-6pin-XX		6000				
DMX-TER-AC-6pin-M		N/A	DMX Terminator	Male	End Cap	
AC-LEADIN-T336		N/A	T-connector for DMX and Power Lead	Combines the power (3 pin male), DMX signal (3 pin male) into a 6 pin female leading end		
AC-P-INJECT-T636			T connector for the 6 pin cable with power injector	T connector 6-pin male to 6-pin female with AC male power injector		