

SMDLCH SURFACE MOUNTED LIGHT INSTALLATION

SMDLCH-1078A-15

IP40 CE

INSTALLATION MANUAL

1. Before installing the fixtures, please read this instruction manual carefully.
2. The lighting fixture should be installed, connected and tested by a certified installer based on the local regulations.
3. Lamps should always be installed or replaced with care.
4. Don't use over rated power lamp.
5. Relamping only can be done when the power is off and the lamp is completely cooled down.
6. When a lamp is cleaned, switch off the fixture and let it cool down completely. Clean the fixture with a soft cloth and a standard PH neutral detergent. Stainless steel finishing should be maintained regularly.
7. Misuse of, or changes to the fixture shall nullify the guarantee.
8. This recessed luminaire shall under no circumstance be covered with insulating matting or similar material.
9. This luminaire is IP20, Indoor use only.

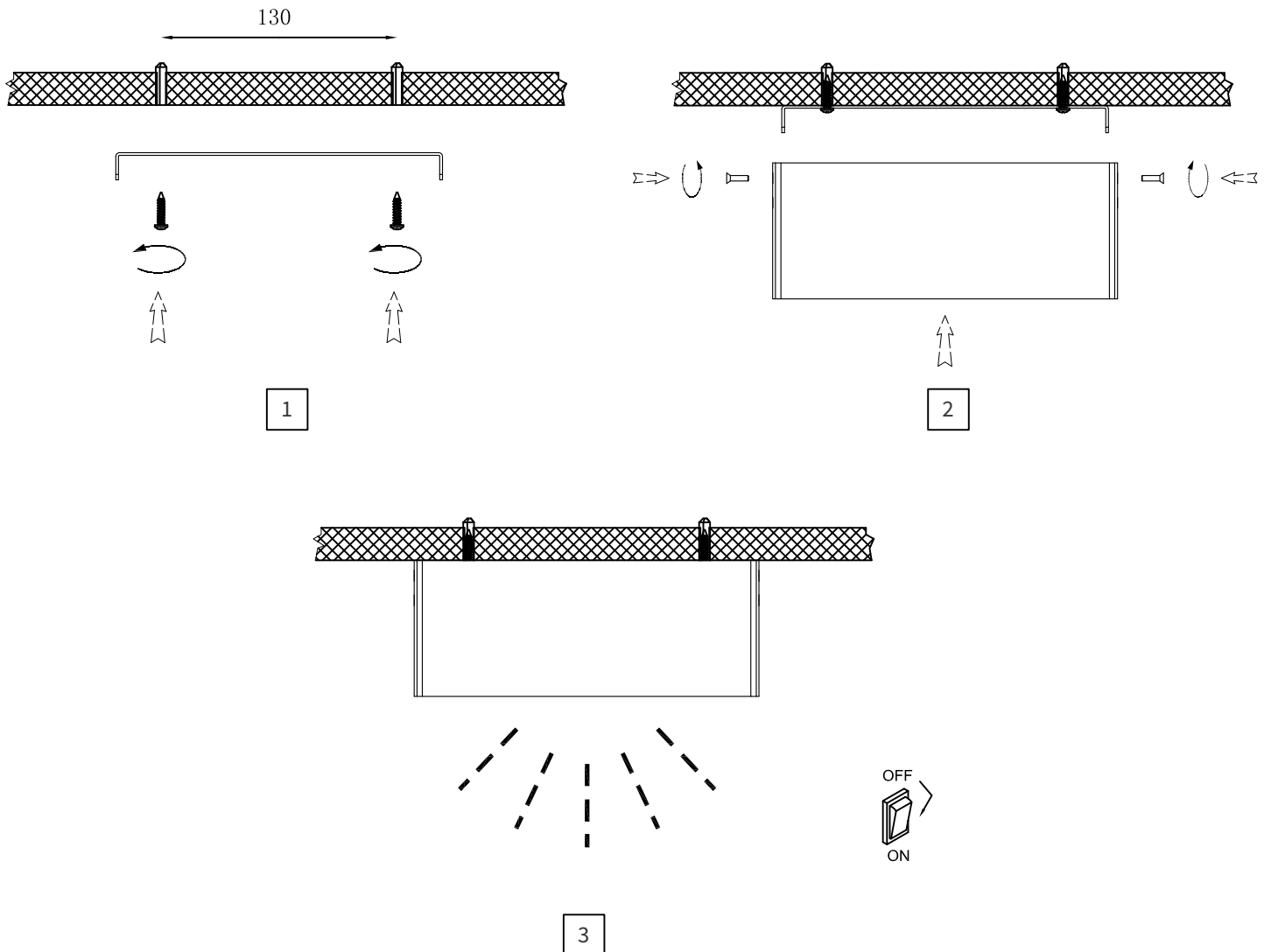
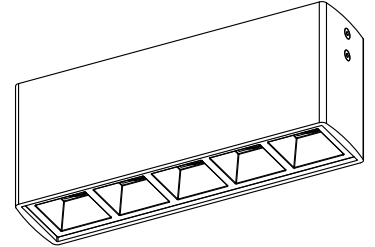

Do not touch or clean the LED array !

